

Change #5
2000 for 2001 #48

RESOLUTION 99-02

WHEREAS, the Board of Fire Commissioners of Clark County Fire District 3 has received petitions from registered voters living on property outside of the current jurisdictional boundaries of Clark County Fire District 3, and,

WHEREAS, the petitioners are requesting to be annexed in to Clark County Fire District 3, and,

WHEREAS, the properties in question will form a contiguous boundary line with the current Clark County Fire District 3 boundary line, and,

WHEREAS, the petitioners represent more than 60% of the eligible registered voters in the area under consideration for annexation (Legal description and map attached).

NOW THEREFORE, Be it resolved that the Board of Fire Commissioners of Clark County Fire District 3 accepts these petitions for annexation.

ADOPTED, by the Board of Fire Commissioners of Clark County Fire District 3 at a regular open meeting thereof this 20th day of January 1999.

Roy Belcoff, Chairman of the Board

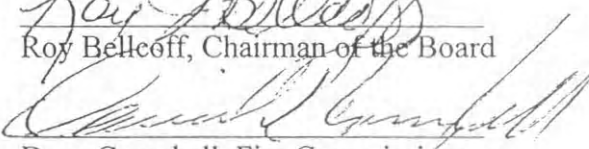
Dave Campbell, Fire Commissioner



Fred Pickering, Fire Commissioner

ATTEST:

Steven G. Wrightson, Secretary to the Board

The area annexed to Fire District 3 is described as follows:

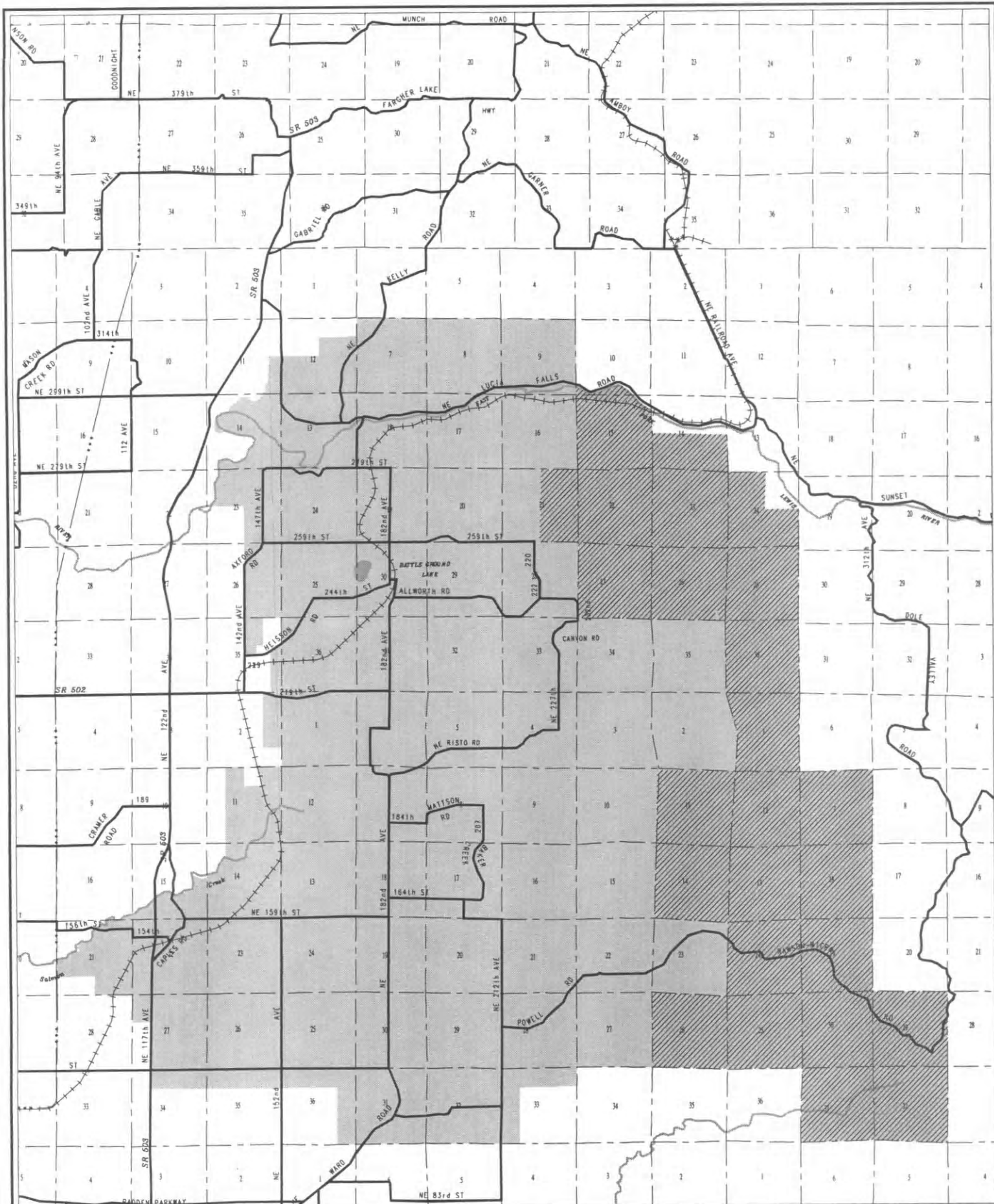
Starting at the Southwest corner of Section 26, T.3.N.-R.3.E., then east two miles to the Southeast corner of Section 25, T.3.N.-R.3.E., then south one mile to the Southwest corner of Section 31, T.3.N.-R.4.E., then east two miles to the Southeast corner of Section 32, T.3.N.-R.4.E., then north two miles to the Northeast corner of Section 29, T.3.N.-R.4.E., then one mile west to the Southeast corner of Section 19, T.3.N.-R.4.E., then north three miles to the Northeast corner of Section 7, T.3.N.-R.4.E., then west one mile to the Southeast corner of Section 1, T.3.N.-R.3.E., then north three and one half miles to the East Quarter corner of Section 24, T.4.N.-R.3.E., then west one half mile to the Center Quarter corner of Section 24, T.4.N.-R.3.E., then north one half mile to the North Quarter corner of Section 24, T.4.N.-R.3.E., then west one half mile to the Southeast Quarter corner of Section 14, T.4.N.-R.3.E., then north one half mile to the East Quarter corner of Section 14, T.4.N.-R.3.E., then west one mile to the East Quarter corner of Section 15, T.4.N.-R.3.E., then north approximately one quarter mile to the Center of the East Fork of the Lewis River, then westerly along the Center of the East Fork of the Lewis River approximately one and one quarter miles to the East line of Section 9, T.4.N.-R.3.E., then south approximately one and one eighth miles to the Southeast corner of Section 16, T.4.N.-R.3.E., then west one half mile to the South Quarter corner of Section 16, T.4.N.-R.3.E., then south one mile to the South Quarter corner of Section 21, T.4.N.-R.3.E., then east one half mile to the Northeast corner of Section 28, T.4.N.-R.3.E., then south one mile to the Southeast corner of Section 28, T.4.N.-R.3.E., then east two miles to the Northeast corner of Section 35, T.4.N.-R.3.E., then south two miles to the Southeast corner of Section 2, T.3.N.-R.3.E., then west one mile to the Northwest corner of Section 11, T.3.N.-R.3.E., then south two miles to the Southwest corner of Section 14, T.3.N.-R.3.E., then east one mile to the Northeast corner of Section 23, T.3.N.-R.3.E., then south one mile to the Southeast corner of Section 23, T.3.N.-R.3.E., then west one mile to the Northwest corner of Section 26, T.3.N.-R.3.E., then south one mile to the point of beginning.



Ordinance #99-02

Information shown on this map was collected from several sources. Clark County accepts no responsibility for any inaccuracies that may be present.

February 24, 2000

Fire District #3

